

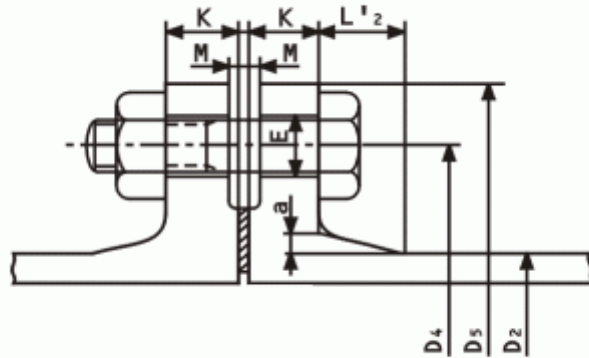

Flanged Joint



Note: Bolt holes shall be spaced evenly on each side of vertical line of flange while the axis of fitting is horizontal.

Unit: mm

Nominal size	O.D.	7.5 kgf/cm <sup>2</sup>								10 kgf/cm <sup>2</sup>									
		Dimensions								Bolt No.	Weight (kg) Flange	Dimensions							
D	D <sub>2</sub>	D <sub>4</sub>	D <sub>5</sub>	K	M	E	a	L' <sub>2</sub>	D <sub>4</sub>			D <sub>5</sub>	K	M	E	a	L' <sub>2</sub>		
75	93.0	268	211	21	3	19	5	26	4	3.77	150	185	18	2	19	5	24	8	2.29
100	118.0	195	238	21	3	19	5	26	4	4.55	175	210	18	2	19	5	24	8	2.76
150	169.0	247	290	22	3	19	5	26	6	6.22	240	280	22	2	23	5	24	8	5.60
200	220.0	299	342	23	3	19	5	26	8	8.06	290	330	22	2	23	5	29	12	6.76
250	271.6	360	410	24	3	23	5	26	8	11.50	355	400	24	2	25	6	30	12	10.70
300	322.8	414	464	25	3	23	5	32	10	14.20	400	445	24	3	25	7	33	16	11.40
350	374.0	472	530	26	3	25	5	32	10	18.80	445	490	26	3	25	7	36	16	13.40
400	425.6	524	582	27	3	25	5	32	12	21.80	510	560	28	3	27	8	39	16	19.40
450	476.8	585	652	28	3	27	5	32	12	28.30	565	620	30	3	27	9	42	20	24.70
500	528.0	639	706	29	4	27	6	32	12	32.00	620	675	30	3	27	9	45	20	28.30
600	630.8	743	810	30	4	27	6	32	16	38.90	730	795	32	3	33	10	51	24	39.00
700	733.0	854	928	31	4	33	6	32	16	49.90	840	905	34	3	33	12	57	24	52.10
800	836.0	960	1034	32	4	33	14	68	20	66.10	950	1020	36	3	33	13	63	28	67.70
900	939.0	1073	1156	33	4	33	15	77	20	85.30	1050	1120	38	3	33	14	71	28	80.30
1000	1041.0	1179	1262	34	4	33	17	84	24	101.00	1160	1235	40	3	39	16	77	28	100.00
1100	1144.0	1283	1366	36	4	33	18	90	24	120.00	1270	1345	42	3	39	17	83	28	122.00
1200	1246.0	1387	1470	38	4	33	19	96	28	140.00	1380	1465	44	3	39	18	89	32	152.00
1350	1400.0	1550	1642	40	4	39	21	110	28	181.00	1540	1630	48	3	45	20	100	36	194.00
1500	1554.0	1710	1800	42	5	39	24	115	32	216.00	1700	1795	50	3	45	22	110	40	239.00
1600	1650.0	1820	1915	47	5	39	24	120	36	275.00	1820	1915	55	5	49	22	110	40	295.00
1650	1701.0	1870	1965	48	5	39	24	120	40	286.00	1870	1965	56	5	49	22	110	40	308.00
1800	1848.0	2020	2115	49	5	39	24	120	44	318.00	2020	2115	60	5	49	22	110	44	358.00
2000	2061.0	2230	2325	51	5	46	25	125	48	360.00	2230	2325	65	5	49	22	110	48	421.00
2100	2164.0	2335	2430	52	5	46	25	125	48	386.00	2335	2430	68	5	49	22	110	52	461.00
2200	2280.0	2440	2550	54	6	46	26	130	52	424.00	2440	2550	71	6	56	22	110	52	494.00
2400	2458.0	2650	2760	56	6	46	28	140	56	538.00	2650	2760	76	6	56	24	120	56	651.00
2600	2684.0	2850	2960	58	6	52	28	140	56	549.00	2850	2960	81	6	56	24	120	60	683.00



SHIN NAN CASTING FACTORY CO., LTD. Unit: mm

Nominal size	O.D.	16 kgf/cm <sup>2</sup>								20 kgf/cm <sup>2</sup>									
		Dimensions							Bolt No.	Weight (kg)	Dimensions							Bolt No.	Weight (kg)
		D <sub>4</sub>	D <sub>5</sub>	K	M	E	a	L <sub>2</sub>			Flange	D <sub>4</sub>	D <sub>5</sub>	K	M	E	a		
75	93.0	160	200	20	2	23	6	23	8	3.01	160	200	22	2	23	6	21	8	3.30
100	118.0	185	225	22	2	23	6	23	8	3.98	185	225	24	2	23	6	21	8	4.33
150	169.0	260	305	24	2	25	8	26	12	7.73	260	305	28	2	25	7	22	12	8.90
200	220.0	305	350	26	2	25	8	29	12	9.89	305	350	30	2	25	7	25	12	11.20
250	271.6	380	430	28	2	27	10	32	12	16.50	380	430	34	2	27	8	26	12	19.60
300	322.8	430	480	30	3	27	11	35	16	19.70	430	480	36	3	27	9	29	16	23.10
350	374.0	480	540	34	3	33	11	36	16	26.00	480	540	40	3	33	9	29	16	30.00
400	425.6	540	605	38	3	33	11	37	16	36.00	540	605	46	3	33	9	29	16	42.80
450	476.8	605	675	40	3	33	13	40	20	47.30	605	675	48	3	33	10	32	20	55.50
500	528.0	660	730	42	3	33	14	43	20	56.30	660	730	50	3	33	11	35	20	65.40
600	630.8	770	845	46	3	39	15	49	24	75.00	770	845	54	3	39	13	41	24	86.10
700	733.0	875	960	50	5	42	17	55	24	98.20	900	995	64	5	48	13	56	24	143.00
800	836.0	990	1085	54	5	48	19	61	24	132.00	1030	1140	72	5	56	14	63	24	213.00
900	939.0	1090	1185	58	5	48	20	67	28	156.00	1140	1250	76	5	56	15	74	28	256.00
1000	1041.0	1210	1320	62	5	56	21	73	28	207.00	-	-	-	-	-	-	-	-	-
1100	1144.0	1310	1420	66	5	56	22	79	32	237.00	-	-	-	-	-	-	-	-	-
1200	1246.0	1420	1530	70	5	56	23	85	32	287.00	-	-	-	-	-	-	-	-	-
1350	1400.0	1590	1700	76	5	62	25	94	32	369.00	-	-	-	-	-	-	-	-	-
1500	1554.0	1750	1865	80	5	62	27	105	36	451.00	-	-	-	-	-	-	-	-	-

Note: 1. 7.5 kgf/cm<sup>2</sup>~20 kgf/cm<sup>2</sup> are the nominal pressure of CNS 7118.

2. Dimensions D4, D5, E and the bolt number of 10 kgf/cm<sup>2</sup>~20 kgf/cm<sup>2</sup> shall be in accordance with CNS 790, CNS 791 and CNS 792.

SHIN NAN CASTING FACTORY CO., LTD.

SHIN NAN CASTING FACTORY CO., LTD.

SHIN NAN CASTING FACTORY CO., LTD.

SHIN NAN CASTING FACTORY CO., LTD.

SHIN NAN CASTING FACTORY CO., LTD.

SHIN NAN CASTING FACTORY CO., LTD.